



您看到了 **真相** 嗎？

台灣很多火災悲劇
是因為…





鐵捲窗打不開 17歲女葬火窟

2014年11月17日 [164](#) [8+1](#) [0](#)



林女疑打不開二樓鐵窗 (箭頭處), 吸入過多濃煙噎死。翻攝畫面

【洪振生／屏東報導】屏東縣車城鄉一名高三少女, 昨上午在家中二樓睡覺, 一樓突然起火, 少女打不開緊閉鐵捲窗, 緊急撥電話向祖父求援, 但祖父趕抵家門時, 眼睁睁地看著孫女被抬上救護車, 少女因吸入過多濃煙搶救無效不治。消防人員初步研判是電線走火釀禍。

警消調查, 死者林姓少女(十七歲)就讀恆春工商, 與祖父林貴水(七十四歲)和父親同住車城鄉射寮村一棟兩層樓建物, 昨上午父親和祖父相繼外出, 少女在二樓房間睡覺。

真的嗎?



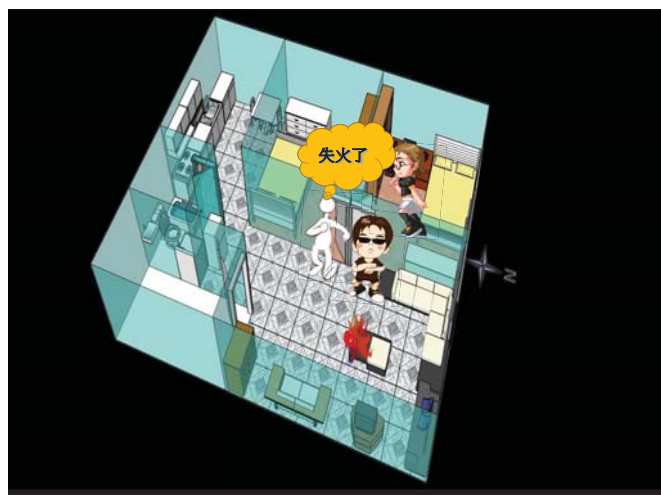
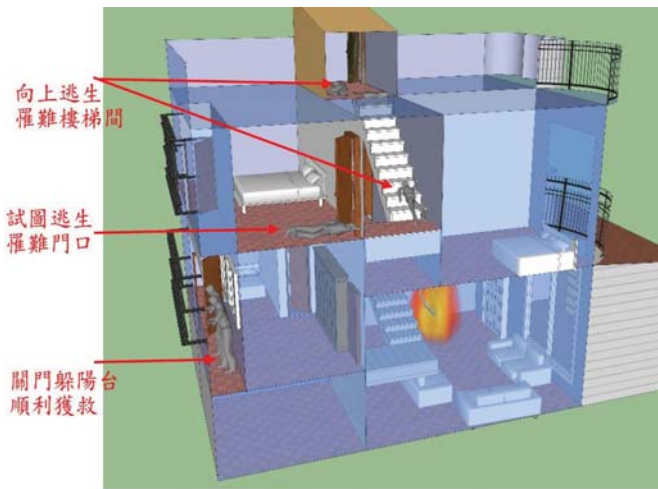

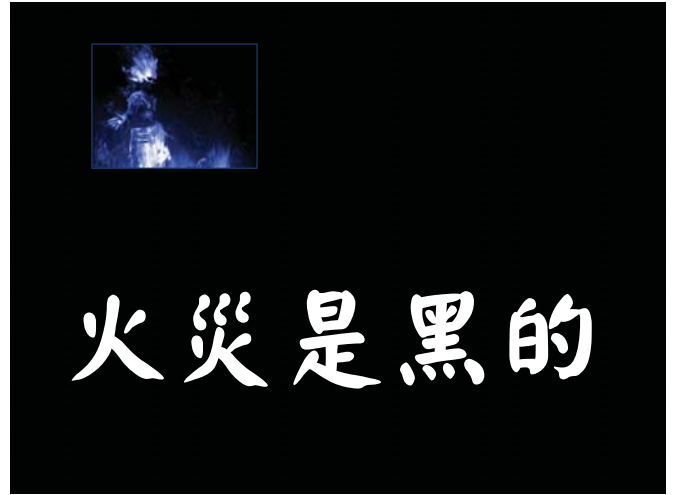

Einsatzstichwort:

Müllcontainerbrand



火災致死的



火災不會事先彩排



HOSTED AT
NOTHINGTOXIC.COM



通道二



停、躺、滾

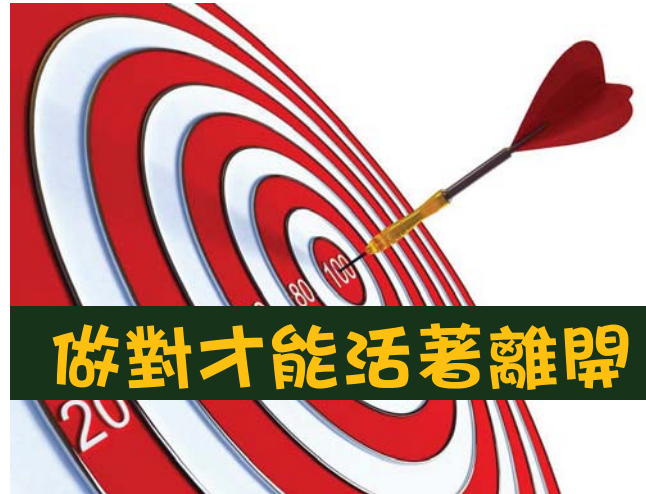

做對才能活著離開

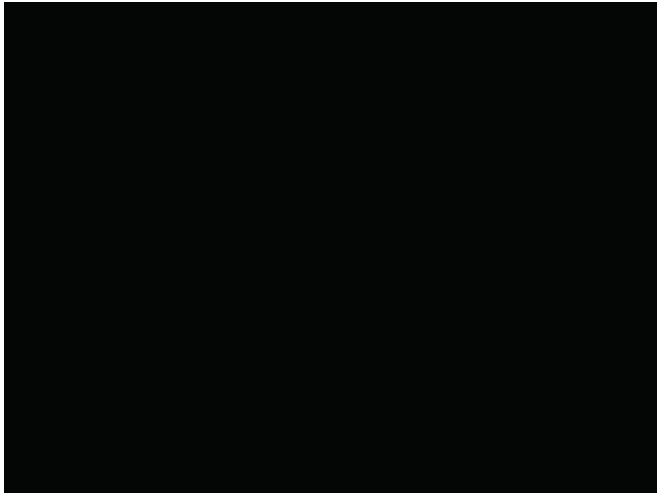

多5%，該有多好？

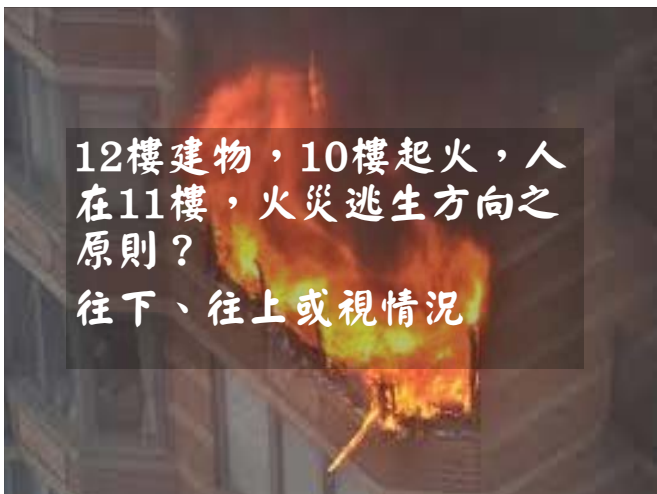

12樓建物，10樓起火，人在11樓，火災逃生方向之原則？
往下、往上或視情況



能逃生代表發現火災夠早
所以逃生路徑上

沒有煙熱

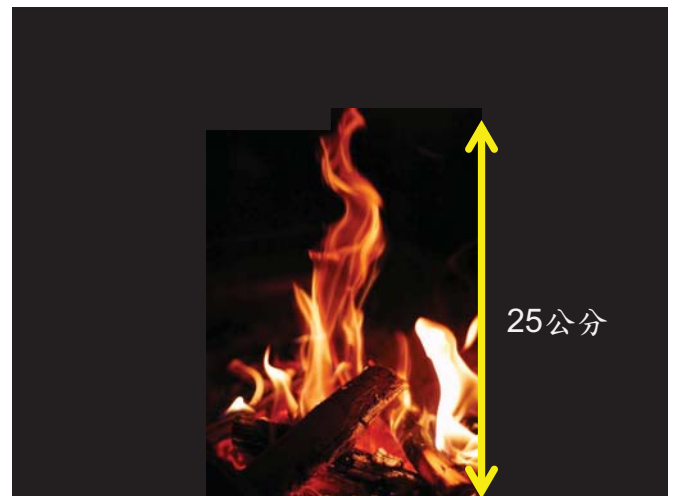

煙熱急遽成長

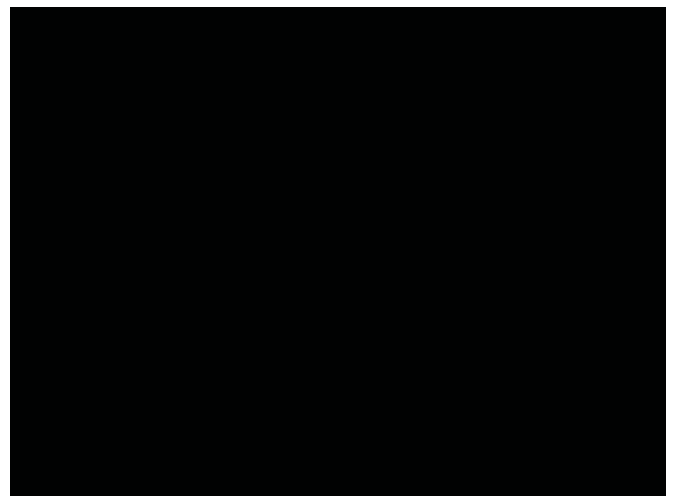

請勿逃生 關門 求生

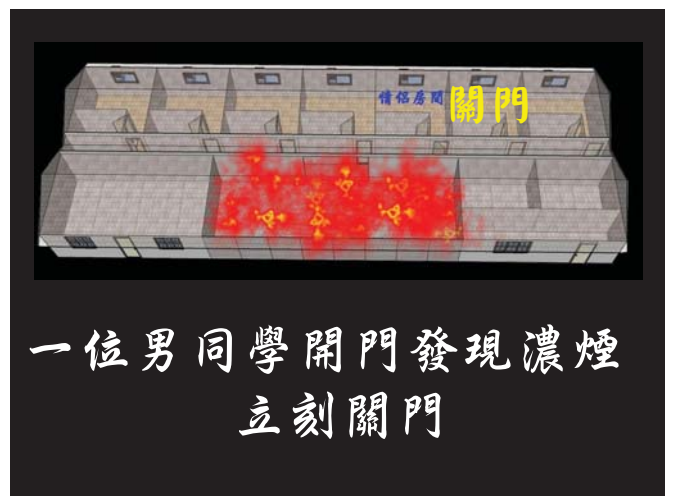
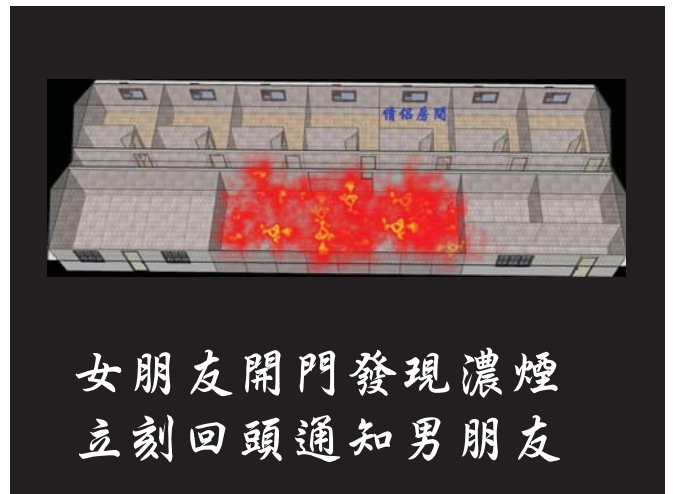





5. SHOULD YOU STAY OR SHOULD YOU GO?

A	B	C
If you live in a NON-FIREPROOF BUILDING and there is a fire, it is usually better (safer) to leave the building immediately.	If you live in a FIREPROOF BUILDING and there is a fire, it is usually better (safer) to stay inside rather than entering smoke-filled hallways, especially if the fire is above your apartment.	If the fire IS IN your apartment, regardless of construction type,
Fireproof does not mean that the building is immune to fire.	<ul style="list-style-type: none"> Stay inside rather than entering smoke-filled hallways, especially if the fire is above your apartment. Keep your door CLOSED. 	<ul style="list-style-type: none"> Get everyone out. Stay low as you go. Use your safest and most accessible exit.

Stay inside rather than entering smoke-filled hallways, especially if the fire is above your apartment.

Keep your door CLOSED.

FDNY PROUDLY SERVING NEW YORK SINCE 1865





關門
火災應變一定要
做的動作

關門待救之原則

- 牆壁、地板是不燃性或耐燃
- 關門擋得住熱
- 關門擋得住煙
- 房間有對外的窗戶



火災現場平面及物品配置圖

(二) 火災場所平面及照相位置圖

關門擋得住熱

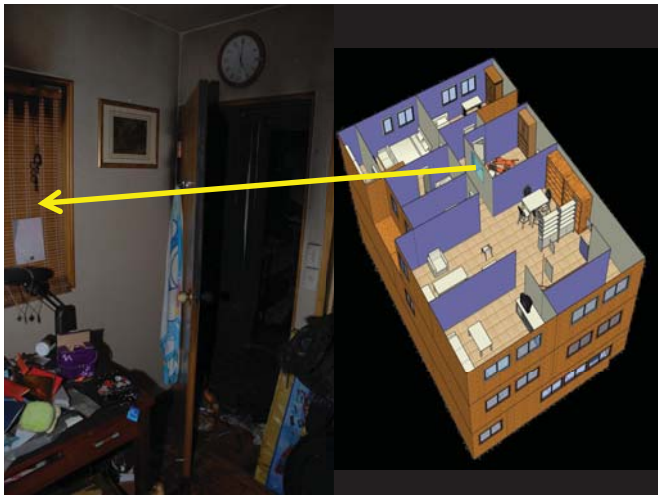

火場頭號殺手

濃煙

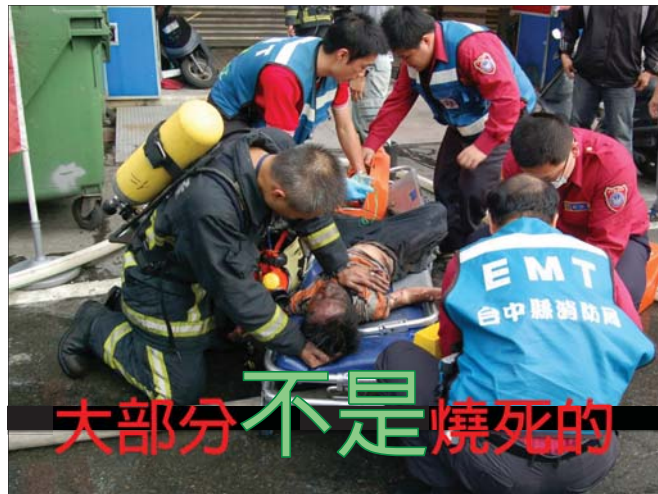

大部分不是燒死的



火燒厝

看到小火走為上策

向下

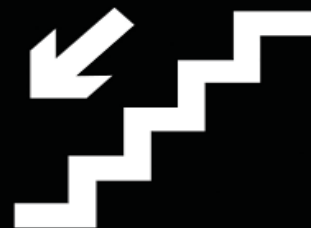

濕毛巾在濃煙中無用



看到濃煙關門大吉



關門



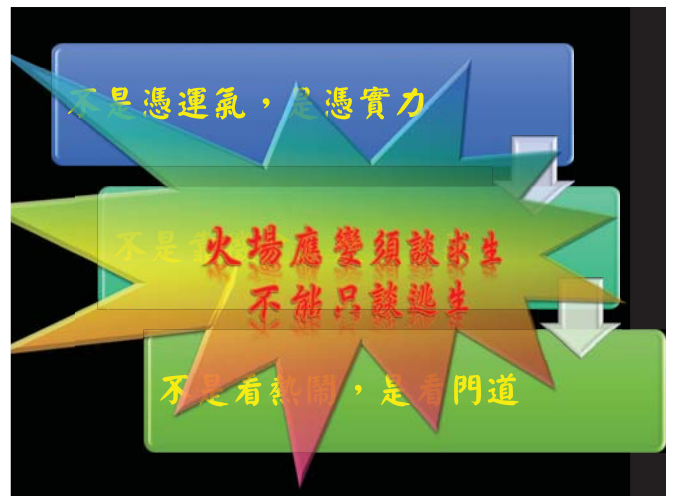

火災不會事先彩排
做對才能活著離開

雙葉書局：02-23684198
<http://www.yehyeh.com.tw/>

